



Nexia
International

NEXIA ASIA PACIFIC CONFERENCE 2018

5th - 7th April 2018
Keio Plaza Hotel Tokyo
Tokyo, Japan

<http://nexia2018.com/>



CONTENTS

KON-NICHIWA! Welcome

- 03** KON-NICHIWA! Welcome
- 04** Conference Information
- 06** Sightseeing Spots in Tokyo
- 08** Program at a Glance
- 10** Conference Program
- 13** Floor Plan
- 14** Guest Speakers
- 18** Dinner Information
- 19** Tour Programs
- 20** Delegate List

We would like to welcome you to Tokyo for the Nexia Asia Pacific Conference 2018. This is a great opportunity to develop relationships and friendships with Nexia colleagues from around the world.

As you will see from the conference program, this is also an opportunity to discuss how to cope with digitalisation especially the application of artificial intelligence in our profession and its impact on the future business environment. These sessions consist of keynote presentations, presentations from the host firm, and panel discussions. In addition, we will have two special sessions – “Health and Wellness” and “Client Experience”.

Tokyo, formerly known as “Edo”, became the capital and largest city of Japan in the Tokugawa Shogunate regime (1603-1867) and now is the centre of Japanese culture, finance, commerce and government with a population of more than 10 million people. Tokyo is also a world-recognised economic and industrial centre. Spring is the best season to travel in Japan, when cherry blossoms are in full bloom and you can enjoy healthy and seasonal fresh foods, especially in “Washoku” with traditional Japanese cuisine, which was registered as an Intangible cultural heritage by UNESCO in 2013.

Once again, we welcome you and your colleagues to Tokyo and we sincerely hope that you really enjoy the Nexia Asia Pacific Conference 2018 and it will lead to many excellent opportunities in the future.

Yours sincerely,

南 成人 

Naruhito Minami
Managing Partner
GYOSEI & CO.

Conference Information

Venue - Keio Plaza Hotel Tokyo



Contact Information - Keio Plaza Hotel Tokyo

Address: 2-2-1 Nishi-Shinjuku, Shinjuku-Ku, Tokyo 160-8330 Japan
Phone : +81 3 3344 0111 Fax :+81 3 3345 8269
Website: <http://www.keioplaza.com/>

Keio Plaza Hotel Tokyo is the ideal location to explore the delights of the city of Tokyo. Only minutes away from the most popular shopping and entertainment spots in Shinjuku, the hotel provides stunning views over central Tokyo. The luxury accommodation of Keio Plaza Hotel allows you to enjoy spectacular city views of Tokyo from wide picture windows. You can select your favorite room type from over 1,437 available guestrooms.

Check-in and Check-out time

Check-in 14:00 Check-out 11:00

The hotel cannot guarantee an early check-in, so if your flight arrives in the early hours, you may wish to book the night before in order to be sure of a room on arrival.

Registration Desk

Registration Desk will be located at the 47 floor of the hotel and will be opened from 8:30 to 17:00 during the conference.

Climate

The climate in Japan is characterized by four distinct seasons: spring, summer, autumn and winter. April in Tokyo is spring with temperatures ranging between 10°C and 20°C or between 50°F and 68°F. This generally means comfortable and crisp, sometimes bit chilly.

Time Zone

The time in Japan is 9 hours ahead of the Greenwich Mean Time (GMT +9).

Electricity

The power supply in Tokyo is 100-Volt 50Hz system. It is recommended that you bring an international travel adaptor/power converter with you.

Currency (as on 14 March 2018)

1 USD = 106.7 JPY 1 EUR = 132.2 JPY 1 GBP = 149.1 JPY 1 AUD = 83.9 JPY
1 CNY = 16.9 JPY 1 INR = 1.7 JPY 10 KRW = 1 JPY 1 SGD = 81.4 JPY

Consumption tax - VAT

Consumption tax is levied on almost all goods and services at a single rate of 8% and is included in the retail price in most cases. Please be careful because only a price excluding tax is sometimes indicated.

Tipping

There is no tipping custom in Japan. Please note that certain upscale restaurants and hotels may add 10% to your bill as a service charge.

Dress code

The dress code for the conference and dinners except for the Gala Dinner is business casual - collared shirts but no t-shirts or jeans. The Gala Dinner on Friday 6th April is formal, this would include business suit / national dress / cocktail dress / formal gala dress.

Sightseeing Spots in Tokyo



◀ **Tokyo Metropolitan Government Office**, built in 1991, is one of Tokyo's landmarks with an observatory on the 45th floor. (Nearest station: Tocho-mae, very close to our venue)



◀ **Shinjuku Gyoen National Garden** was originally created as a garden for the Imperial Family in 1906 and is currently a national garden, harmonising both European and Japanese styles. (Nearest station: Shinjuku-Gyoen-mae)

▶ **Tokyo Tower**, built in 1958, the broadcasting tower, is 333 meters (1,093ft) high. You can enjoy a view of the entire city of Tokyo from the 150meters (492ft) and 250meters (820ft) high observatory. (Nearest station: Kamiya-cho)



▶ **The State Guest Houses** are the government facilities established to accommodate heads of the states, prime ministers and other honoured guests from abroad. (Nearest station: Yotsuya)



◀ **Tokyo Skytree** built in 2012, is a broadcasting, restaurant and observation tower. It is the tallest structure in Japan, 634 meters (2,080ft) high. (Nearest station: Tokyo Skytree)



◀ **Tokyo Station**, the Renaissance-style redbrick architecture built in 1914 and fully renovated in 2012, is the central station of Tokyo Metropolitan. The building of Tokyo Station was registered as an "Important Cultural Properties in Japan" in 2003.

Program at a Glance

Venue	5 April (Thu)			6 April (Fri)				7 April (Sat)				Venue						
	AP	MFL		AP	MFL			AP	MFL									
	Akebono	Asahi	Aozora	Akebono	Asahi	Akane	Aozora	Akebono	Asahi	Akane	Aozora							
08:30 - 09:00	Registration			Registration				Registration				08:30 - 09:00						
09:00 - 09:30	Registration			Main Conference 09:00 - 11:10	MFL Course 09:00 - 11:10			Main Conference 08:45 - 10:30	MFL Course 09:00 - 09:15			09:00 - 09:30						
09:30 - 10:00	Tax Group Meeting 10:00 - 11:10	MFL Course 10:00 - 11:10											MFL Course / Group Work 09:15 - 10:30	MFL Course / Group Work 09:15 - 10:30	MFL Course / Group Work 09:15 - 10:30	09:30 - 10:00		
10:00 - 10:30																		10:00 - 10:30
10:30 - 11:00			Tea Break 11:10 - 11:30				Tea Break 11:10 - 11:30				Tea Break 10:30 - 10:55	10:30 - 11:00						
11:00 - 11:30				Main Conference	MFL Course			Main Conference 10:55 - 12:30	MFL Course / Group Work 10:55 - 12:45	MFL Course / Group Work 10:55 - 12:45	MFL Course / Group Work 10:55 - 12:45	11:00 - 11:30						
11:30 - 12:00	Tax Group Meeting	MFL Course																
12:00 - 12:30																		
12:30 - 13:00			Lunch / Buffet	Photo Session AP & MFL			Lunch / Buffet	Lunch / Bento Box 12:30 - 13:10			Lunch / Bento Box 12:45 - 13:45	12:30 - 13:00						
13:00 - 13:30														13:00 - 13:30				
13:30 - 14:00								Half Day Tour 13:40 - 18:00				13:30 - 14:00						
14:00 - 14:30	Audit Group Meeting 14:00 - 15:10	MFL Course 14:00 - 15:10		Main Conference	MFL Course 14:00 - 14:15				MFL Course 13:45 - 14:45				14:00 - 14:30					
14:30 - 15:00												Tea Break 14:45 - 15:00				14:30 - 15:00		
15:00 - 15:30			Tea Break 15:10 - 15:35		MFL Course / Group Work 14:15 - 16:00	MFL Course / Group Work 14:15 - 16:00	MFL Course / Group Work 14:15 - 16:00			MFL Course			15:00 - 15:30					
15:30 - 16:00	Audit Group Meeting 15:35 - 17:00	MFL Course 15:35 - 18:00										15:30 - 16:00						
16:00 - 16:30							Main Conference	MFL Course / Group Work	MFL Course / Group Work	MFL Course / Group Work				16:00 - 16:30				
16:30 - 17:00												16:30 - 17:00						
17:00 - 17:30												17:00 - 17:30						
17:30 - 18:00												17:30 - 18:00						
18:00 - 18:30												18:00 - 18:30						
18:30 - 19:00	Depart at 18:30 by bus							Depart at 18:30 on foot				18:30 - 19:00						
19:00 - 19:30	Welcome Dinner @ Meiji-Kinenkan Japanese Cuisine			Cocktail Reception @ Keio Plaza Hotel				Farewell Dinner @ The Sakura Dining Tokyo Super Buffet				19:00 - 19:30						
19:30 - 20:00																	19:30 - 20:00	
20:00 - 20:30																		20:00 - 20:30
20:30 - 21:00																		20:30 - 21:00
21:00 - 21:30				Gala Dinner @ Keio Plaza Hotel / Nishiki French Cuisine								21:00 - 21:30						
21:30 - 22:00												21:30 - 22:00						

*Accompanying person Tour Program : 09:00 - 16:00 on April 6

Conference Program

05 April 2018 (Thursday) (Tax and Audit Group Meetings)

8:30 Registration Open

Asia Pacific Tax Group Meeting

Chair: Krupal Kanakia / YoungChang Kwon

10:00 – 10:10 Welcome and Introduction

10:10 – 10:30 Japanese Tax System

10:30 – 11:10 Country Presentations - Recent Tax Updates / China and India

11:10 – 11:30 Morning Tea

11:30 – 11:50 Technical Presentation

11:50 – 12:55 Case Study and Country Wise discussion / Introduction of case study and panel discussion

12:55 – 13:00 Closure

13:00 – 14:00 Lunch // Buffet

Asia Pacific Audit Group Meeting

Chair: Andrew Hoffmann, Chin Chee Choon & Trung

14:00 – 14:05 Welcome and Introduction

14:05 – 14:50 Audit Case studies - Three case studies dealing with more complex accounting and audit issues. (India, Japan, Korea)

14:50 – 15:10 Audit Methodology - Pros and cons in using the major audit methodology software (CCH, Caseware)

15:10 – 15:35 Afternoon Tea

15:35 – 16:10 Digitalisation panel discussion
- Moderator led panel discussion on experiences in using data analytics and related software and techniques.

16:10 – 16:25 Using BEAN and KMA - Experiences in using software one year on

16:25 – 16:55 Accounting Standards Updates plus Regional Updates

16:55 – 17:00 Closure

19:00 – 21:30 Welcome Dinner (Meiji-Kinenkan) (Outside by bus)

06 April 2018 (Friday) (Main Conference)

Chair of the Day: Suhartono SA

8:30 Registration Open

09:00 – 09:10 Opening Remarks
Speaker: Suhartono SA

09:10 – 09:15 Radio Calisthenics No.1
Speaker: Makoto Iwabuchi

09:15 – 09:25 Welcome Note
Speaker: Ian Stone

09:25 – 09:40 Welcome by Host Firm
Speaker: Naruhito Minami

09:40 – 10:10 Keynote Presentation - Artificial Intelligence in Japan and its impact on business and financial sector.
Speaker: Naoki Ohgo

10:10 – 11:10 Nexia International Update
Speaker: Kevin Arnold

11:10 – 11:30 Morning Tea

11:30 – 11:50 What can we learn from the use of digitalisation and how do we implement digitalisation process?
Speaker: Tsuneo Nakamura

11:50 – 12:30 Panel discussion by Nexia Member Firms (Australia, Singapore, Hong Kong, India and Japan)

12:30 – 13:00 Photo Session

13:00 – 14:00 Lunch // Buffet

14:00 – 16:00 Asia Pacific Strategy
AP board & International Committee Member Updates

16:00 – 16:30 Afternoon Tea

16:30 – 17:20 How do our large firms do target marketing? What can you learn?
Speaker: Steven Drew and Nasoul Gopal and Larry Chastang

17:20 – 17:30 Closure / Announcements
Speaker: Suhartono SA

19:00 – 22:00 Gala Dinner (at Keio Plaza Hotel)

Conference Program

Floor Plan

07 April 2018 (Saturday) (Main Conference)

Chair of the Day: Viet Nga Nguyen

8:30	Registration Open
08:45 – 08:55	Opening Remarks <i>Speaker: Viet Nga Nguyen</i>
08:55 – 09:00	Radio Calisthenics No.2 <i>Speaker: Makoto Iwabuchi</i>
09:00 – 09:40	Health and Wellness Japanese Longevity - The secrets might be in the Japanese lifestyle <i>Speaker: Chise Mori</i>
09:40 – 10:10	Understanding Cultural Differences <i>Speaker: Gary Yong</i>
10:10 – 10:30	Introducing New Firms
10:30 – 10:55	Morning Tea
10:55 – 11:35	Client Experience - Value of long term relationships - Doing business in Japan <i>Speaker: Harish Sachdeva</i>
11:35 – 11:55	Understanding the Secondment Program and its benefits - real examples <i>Speaker: Yohei Kondo</i>
11:55 – 12:10	2019 APAC Conference (Vietnam) <i>Speaker: Nexia STT</i>
12:10 – 12:30	Closure <i>Speaker: Ian Stone</i>
12:30 – 13:10	Lunch // Bento Box
13:40 – 18:00	Half-day Tour
19:00 – 21:30	Farewell Dinner (The Sakura Dining Tokyo) (Outside on foot)

The schedule and the sessions are subject to change.

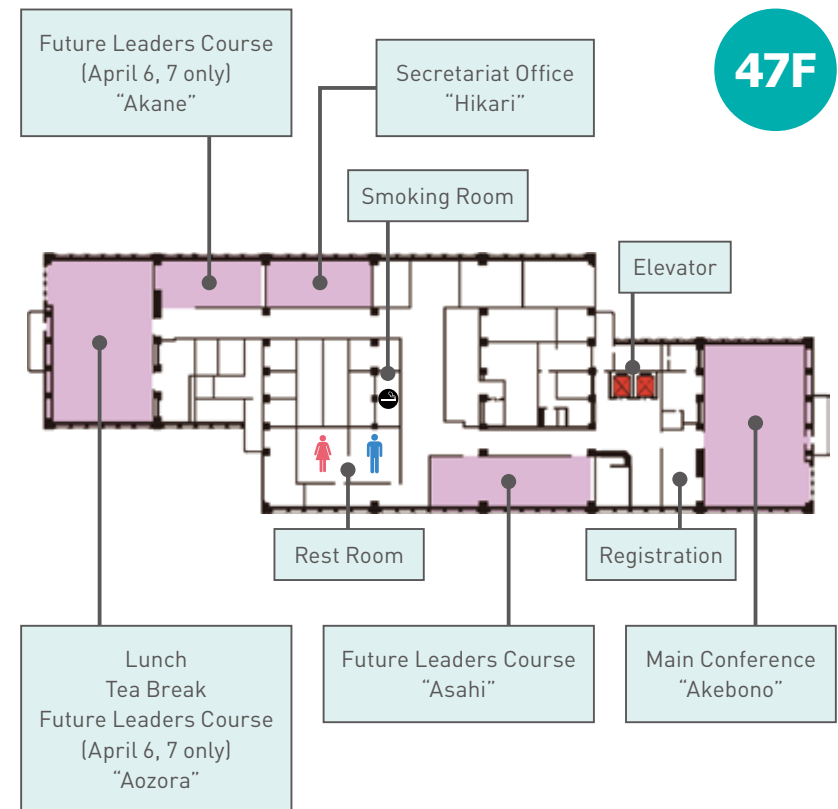

Guest Speaker Keynote Presentation

Guest Speaker Health and Wellness

Profile

Naoki Ohgo

The CEO of RootF Inc. and RootF Datum Inc.



Naoki Ohgo is currently the CEO of RootF Inc., a consulting company for management reform established in 2008 and the CEO of RootF Datum Inc., an artificial-intelligence-based data science and consulting firm, established in 2017. In addition, he is also serving as a senior advisor to Financial Research Center of Financial Services Agency and is a senior executive advisor to Hiroshima Prefecture.

Before he established RootF Inc. in 2008, he worked for McKinsey & Company from 1985 to 2005. After pursuing a career in consulting in Tokyo, Stockholm and Seoul offices of McKinsey & Company, he was elected as a partner in 1999 and engaged in consulting services for management reforms of many financial institutions as a head of the Tokyo office's Retail Banking Practice Division. In 2005, he moved to GE Money Japan and served as a managing director of business development until 2008.

He finished his undergraduate studies in the department of mathematics of faculty of science at University of Tokyo in 1985.

Presentation Title

– Artificial Intelligence in Japan and its impact on business and financial sector

Profile

Chise Mori

The chief health coach of the Sophiawoods Institute



Chise Mori is the founder and the chief health coach of the Sophiawoods Institute. She is a certified integrative nutrition health coach (CINHC), a board-certified holistic health practitioner in alternative medicine in the USA, and a certified international health coach (CIHC).

Utilizing those knowledge and skills, Chise provides business persons and corporations a support in achieving better health and happiness through her private health coaching program, workshops, seminars, and her one-year mind-body medicine course. Chise is a member of Smart Life Project led by Ministry of Health, Labor, and Welfare of Japan as well.

Chise has an MBA with a concentration in Accounting and Finance, and is a licensed securities handler, who had worked as Director in PricewaterhouseCoopers and in the Finance and Economic Research Institute of the Nomura Securities for a total of 20 years before her career change.

Chise enjoys playing the flute, cooking and yoga. She has lived in Japan, the USA, Germany and Estonia, and traveled many more countries.

Presentation Title

– Japanese Longevity – The secrets might be in the Japanese lifestyle

Guest Speaker Client Experience

Profile

Harish Sachdeva

The CEO of Meritech



Harish Sachdeva born and brought up in a small town of District Karnal in Haryana – India, came to Japan in 1997 for the first time while perusing his Masters of Kurukshetra University India. He came to Japan to work for Nihon Kohden as a trainee Software Engineer for 6 months. After the successful completion of the training, he was appointed as Staff Engineer with the same company in 1998.

After working 3 years with Nihon Kohden, he joined a startup company in Japan called Metatron Technologies as Product Engineer before moving up to the rank of Sales Manager within 3 years. He handled large accounts like J-Phone (now SoftBank) and TU-KA cellular (now merged with KDDI) Japan.

In year 2003, he co-founded his current company Meritech in Japan. This company was started with just 2 engineers now has 70+ engineers and a development center in India. Meritech is the primary vendor of Japan's number one operator – **NTT docomo** for network optimization solutions. Meritech's customer base include **SoftBank, KDDI, NEC, Nokia, Fujitsu** and other major companies in Japan.

Harish is a firm believer that the **solution to all the existing problems** in India is “**right education**” to its children. Therefore for serving his motherland, and for the bright future of India; Harish started a school in his hometown Kurukshetra. In 7 years, the school has grown from 237 students to 2200+ students and from 59 employees to 263 employees.

#	Academic Year	Number of Students	Number of Staff in School
1.	2011-12	237	59
2.	2012-13	515 (+278)	83 (+24)
3.	2013-14	811 (+296)	109 (+26)
4.	2014-15	1136 (+325)	137 (+28)
5.	2015-16	1405 (+269)	155 (+18)
6.	2016-17	1835 (+430)	210 (+55)
7.	2017-18	2221 (+416)	263 (+53)

Harish firmly believes that the right education can make today's children the leaders of next generation. He serves as Chairman of this school.

Harish holds a bachelor's degree in Electrical Engineering and a Master's degree in Computer Science and Technology from Kurukshetra University, India.

Harish owns or runs the following business and school in Japan and India.

1. Meritech Company Overview

<http://www.meritecholutions.com>

Meritech is a leading company for **Mobile Network Monitoring and Performance Optimization** solutions offering several innovative products that monitor and optimize LTE, WCDMA, HSPA, GSM/GPRS and Wi-Fi network performance.

Meritech is focused on providing exceptional products that fill the need for mobile wireless industry. To insure that its products are easy to use and effective, Meritech backs its products with a team of highly dedicated professionals software and RF engineers. Leveraging wireless expertise and software development capabilities, Meritech engineers work very closely with leading network operators and vendors in Japan to customize products to meet new industry standards.

2. Wisdom World School, Kurukshetra Overview

a. <http://www.wisdom.edu.in>

b. <https://facebook.com/WisdomWorldSchool>

Wisdom World School, Kurukshetra was established in 2011 under the aegis of **Wisdom Social Welfare Trust**, New Delhi. Wisdom's management firmly believes that the remedy of most of the ills that plague our society today lies in the spread of education. The fundamental objective of the school is to provide the students real quality education and exposure so that they can be wise enough to decide the right course of life. Within a span of 5years, WWS has carved a niche in the region as a hub of quality education with a focus on all-round harmonious growth of students.

Presentation Title

– Value of long term relationships when doing business in Japan

Dinner Information

Tour Program

Welcome Dinner



Date & Time	5 April (Thu) 19:00 – 21:30
Departure Time & Location	18:30, 3F Lobby
Venue	Meiji Kinenkan
Dress Code	Smart Casual

Meiji Kinenkan is the first wedding hall in Japan since 1947 with large Japanese garden managed by the Meiji Shrine. This restaurant offers ultimate and traditional Japanese food arranged with seasonal ingredients.

* The bus will be arranged from the hotel to Meiji-Kinenkan (approx.20 minutes). Our staff will escort you.

Gala Dinner



Date & Time	6 April (Fri) 19:00 – 22:00
Venue	Nishiki, 4 th Floor of Keio Plaza Hotel
Dress Code	Formal

We will enjoy Cocktail Reception followed by Gala Dinner with broad range of quality Western Cuisine and excellent Japanese entertainment in a relaxing and atmospheric space.

Farewell Dinner



Date & Time	7 April (Sat) 19:00 – 21:30
Departure Time & Location	18:30, 3F Lobby
Venue	The Sakura Dining Tokyo
Dress Code	Smart Casual

This restaurant offers "Super Buffet", where all the dishes on the buffet table are fresh from the oven. We will enjoy the last event for Nexia Asia Pacific Conference 2018 with our Nexia friends.

* Approx. 5 minute walk will take you to the restaurant from the hotel and our staff will escort you.

Accompanying Person Tour – Experience Japanese Culture and Enjoy Shopping

DATE & TIME: 6 April (Fri) 9:00 – 16:00

DEPARTURE TIME & LOCATION: 8:50 at 3F Lobby

Time	Program
8:50 – 9:00	Meet at 3F Lobby
9:00 – 15:30	Move to the Imperial Palace *1
	Walking in the Imperial Palace Plaza
	Move to Nihon-Bunka-Kyoshitsu
	"Sado" (tea ceremony) experience *2
15:30 – 16:00	Move to Ginza
	Lunch at Ginza *3
	Shopping around Ginza
15:30 – 16:00	Go back to Hotel



*1 The Edo Castle, formerly Tokugawa Shogunate Family's residence, became the Imperial Palace in 1868. Part of the site is opened to the public as the Imperial Palace East Park. The Nijubashi Bridge in front of the main entrance is famous.

*2 "Sado" is Japanese tea ceremony of serving and having tea. The tea used for "Sado" or tea ceremony is called "matcha" and it is beautiful green powder. Japanese sweets called "ocha gashi (tea sweets)" are served with green tea.

*3 A world-renowned shopping district for sophisticated adults, Ginza is an elegant and stylish town where a retro-modern atmosphere still lingers in the air.

Half Day Tour – Encounter a Fusion of the Historical and the Modern in Tokyo, a city of waterways

DATE & TIME: 7 April (Sat) 13:40 – 18:00

DEPARTURE TIME & LOCATION: 13:30 at 3F Lobby

Time	Program
13:30 – 13:40	Meet at 3F Lobby
13:40 – 17:20	Move to Asakusa
	Sightseeing in Asakusa *1
	Cruising in Sumida-gawa River and Tokyo Bay *2
17:20 – 18:00	Sightseeing and Shopping in Odaiba *3
	Go back to Hotel



*1 The time has stopped here since the Tokugawa Shogunate era, which is reflected by the numerous stores in Asakusa. Take a walk and you can step back in time. Senso-ji in Asakusa is the oldest temple in Tokyo, which was built in 628.

*2 We will enjoy one hour cruising by water bus in Sumida-gawa River and Tokyo Bay from Asakusa to Odaiba.

*3 The water front area, Odaiba, offers all kind of entertainments with huge amusement zone where you can enjoy shopping, delicious food, entertainment and view of Tokyo Bay all at once.

Delegate List

Delegate listed by country

Country	Firm	Delegate
Australia	LWK Chartered Accountants	Stephen K Liu
	Accompanying person	Helen M Liu
	Nexia Australia / Brisbane	Jason I Prosser
	Accompanying person	Kim P Prosser
	Nexia Australia / Brisbane	Nigel D Bamford
	Accompanying person	Bronwyn E Bamford
	Nexia Australia / Melbourne	Richard Cen
	Nexia Australia / Melbourne	Vito Interlandi
	Accompanying person	Josephine Interlandi
	Nexia Australia / Perth	Mal Di Giulio
	Accompanying person	Gwen Di Giulio
	Nexia Australia / Sydney	Andrew S Hoffmann
	Nexia Australia / Sydney	Craig Wilford
	Nexia Australia / Sydney	Ian D Stone
	Nexia Australia / Sydney	Neil R Hillman
	Accompanying person	Narelle S Hillman
	Nexia Australia / Sydney	Paul William Lenton
Nexia Australia / Sydney	Russell J Reid	
Nexia Australia / Sydney	Stephen W Davis	
Pilot Partners	Jason S Bayliss	
Bangladesh	MABS & J Partners	Nasir Uddin Ahmed
	MABS & J Partners	Muhammad Shajedul Hoque Talukder
China	Beijing Yongtuo CPAs LLP	Kam Por Cheng

Country	Firm	Delegate
China	Beijing Yongtuo CPAs LLP	Jiang Lyu
	Beijing Yongtuo CPAs LLP	Weishi Lyu
	Beijing Yongtuo CPAs LLP	Fengge Xie
	CHUNG RUI TAX GROUP Ltd.	Yuanquan He
	CHUNG RUI TAX GROUP Ltd.	Bin Wei
	Guangzhou Xin Zhong Nan CPAs Co. Ltd.	Hiltung Fang
	Nexia HDDY	Joanna Gong
	Nexia HDDY	Zhenyu Zhu
	Xin Lian Yi Certified Public Accountants Co., Ltd.	Xixiang Guo
	Zhong Xing Hua Certified Public Accountant LLP	Kaiyan Feng
	Zhong Xing Hua Certified Public Accountant LLP	Shixin Huang
	Zhong Xing Hua Certified Public Accountant LLP	Zunnong Li
	Zhong Xing Hua Certified Public Accountant LLP	Ziming Xu
Zhong Xing Hua Certified Public Accountant LLP	Liming Zhu	
Hong Kong	Fan, Chan & Co.	Vickie Ping Wai Fan
	Fan, Chan & Co.	Kwong Kin Leung
	Nexia Charles Mar Fan Limited	Thomas Yue Ting Wong
India	Chaturvedi & Shah	Krupal R Kanakia
	SKP Business Consulting LLP	Maulik Doshi
	SKP Business Consulting LLP	Manoj Gidwani
Indonesia	Kanaka Puradiredja Suhartono	Florus Daeli
	Kanaka Puradiredja Suhartono	Tan Siddharta
	Kanaka Puradiredja Suhartono	Suhartono Soegijanto Atmodihardjo

Delegate List

Delegate listed by country

Country	Firm	Delegate
Japan	Gyosei & Co.	Naoko Enomoto
	Gyosei & Co.	Makoto Iwabuchi
	Gyosei & Co.	Akira Miyajima
	Gyosei & Co.	Masaru Satomi
Malaysia	Nexia SSY	Jason Sze Wan Sia
	Accompanying person	Michelle Voon Sze Yong
	Nexia SSY	Yoon Shing Yong
	Accompanying person	Deborah Carol Jansz
Malta	Nexia BT	Karl Cini
	Accompanying person	Robert Bondin Carter
Nepal	BRS Neupane & Co.	Anup Kumar Shrestha
	Accompanying person	Shobha Devi Shrestha
	Accompanying person	Ashim Shrestha
Netherlands	FSV Accountants & Advisors	Michel Girbes
	FSV Accountants & Advisors	Kjeld Verhoeven
Philippines	Maceda Valencia & Co.	Antonio Obial Maceda, Jr.
Singapore	Nexia TS Public Accounting Corporation	Henry Tan
	Nexia TS Public Accounting Corporation	Chee Choon Chin
	Nexia TS Public Accounting Corporation	Loh Ji Kin
	Nexia TS Public Accounting Corporation	Meriana Ang
South Korea	Nexia International	Kristin YoonSook Kim
	Nexia Samduk	Young-chul Jang

Country	Firm	Delegate
South Korea	Nexia Samduk	Yong Ha Kim
	Accompanying person	Seung Min Chae
	Nexia Samduk	Young Chang Kwon
	Nexia Samduk	Hongbae Choi
	Accompanying person	Shinja Lee
	Nexia Samduk	Hyunsoo Kwon
	Accompanying person	Sang Myung Shin
	Nexia Samduk	Inseok Song
Sri Lanka	Nexia Samduk	Jisun Son
	B. R. De Silva & Co	Lasantha R Perera
Thailand	B. R. De Silva & Co.	Lincoln C Piyasena
	Professional Auditing Service Co., Ltd.	Natthapol Musikaparn
United Kingdom	Professional Auditing Service Co., Ltd.	Michiteru Nara
	Nexia International	Kevin Arnold
United States of America	Nexia International	Darren Enderson
	Nexia International	Annabel Zhu
	Smith & Williamson LLP	Stephen Drew
	Smith & Williamson LLP	Nasoul Gopal
	CliftonLarsonAllen LLP	Larry J Chastang
Viet Nam	Accompanying person	Patty Chastang
	CohnReznick	Cindy Fang
	MaloneBailey LLP	Xiaodong (George) Qin
Viet Nam	Nexia STT	Trung Thanh Nguyen
	Nexia STT	Nga Viet Nguyen

NEXIA ASIA PACIFIC CONFERENCE 2018 Tokyo



GYOSEI & CO.

Kojimachi Bldg. 2F, 3-3-6 Kudan Minami, Chiyoda-ku, Tokyo 102-0074, Japan

Phone: +81-3-5211-7878 Fax: +81-3-5211-7879

<http://www.gyosei-grp.or.jp/english/>

© 2018 GYOSEI & Co. All rights reserved.
GYOSEI & CO. is an independent member of Nexia International, a worldwide association of independent accounting and consulting firms.

Nexia International is a leading worldwide network of independent accounting and consulting firms, providing a comprehensive portfolio of audit, accountancy, tax and advisory services. Nexia International does not deliver services in its own name or otherwise. Nexia International and its member firms are not part of a worldwide partnership. Nexia International does not accept any responsibility for the commission of any act, or omission to act by, or the liabilities of, any of its members. Each member firm within Nexia International is a separate legal entity. Nexia International does not accept liability for any loss arising from any action taken, or omission, on the basis of the content in this publication. Professional advice should be obtained before acting or refraining from acting on the contents of this publication. Any and all intellectual property rights subsisting in this document are, and shall continue to be, owned by (or licensed to) Nexia International Limited. References to Nexia or Nexia International are to Nexia International Limited.